

Anchor Nuts (Metric)

KM3000

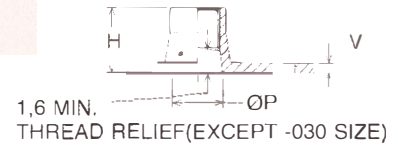

IDENTIFY "F" FOR
F SUFFIX PARTS

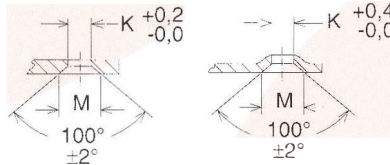
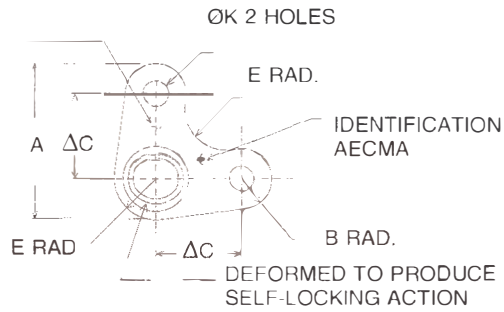

DETAIL "BC" CODED PARTS
METHOD OPTIONAL TO SUPPLIER

PART NUMBER	THREAD		A MAX	B REF	C Δ	E REF	H MAX	K +0,2 -0,0	M ±0,25	P ±0,05	MAX
KM3000-030	M3	0.50	11,5	2,5	6,0	3,0	3,2	2,5	4,8	—	0,70
KM3000-040	M4	0.70	15,5	3,0	8,5	4,0	5,2	2,5	4,8	4,2	1,00
KM3000-050	M5	0.80	17,0	3,0	9,5	4,5	6,2	2,5	4,8	5,2	1,00
KM3000-060	M6	1,00	19,5	3,5	11,0	5,0	7,1	3,3	6,0	6,2	1,25
KM3000-080	M8	1,25	23,0	3,5	13,0	6,3	8,2	3,3	6,0	8,4	1,65
KM3000-080F	M8	1,00	23,0	3,5	13,0	6,3	8,2	3,3	6,0	8,4	1,65
KM3000-100	M10	1,50	28,8	4,5	16,0	8,1	9,9	3,3	6,0	10,4	1,75
KM3000-100F	M10	1,25	28,8	4,5	16,0	8,1	9,9	3,3	6,0	10,4	1,75

MATERIAL: C1050 carbon steel per AMS 5085 (UNS G10500).

FINISH: Cadmium plate per QQ-P-416, Type II, Class 2 and Kaylube molybdenum disulfide dry film lubricant per MIL-L-46010.

THREAD DATA: Thread Profile: ISO 5855/1 and to MJ minor dia.
Tolerances: ISO 5855/2. Class 4H5H.

PERFORMANCE: AECMA 2053 (Tensile strength based on 1100 MPa).

TEMPERATURE: 235°C.

DIMENSIONS: NFL 22553. LN 29675.

VARIATION: Add "BC" for bottom c'sunk rivet holes.
Example: KM3000-050BC.

NOTE: Δ The centre tap hole shall not deviate from the centre of the plate nut, as determined by the rivet holes, by more than 0,1 mm.

KM3000

ANCHOR NUT

CORNER, METRIC

KM3000



Anchor Nuts (Imperial)

K3000



K3000

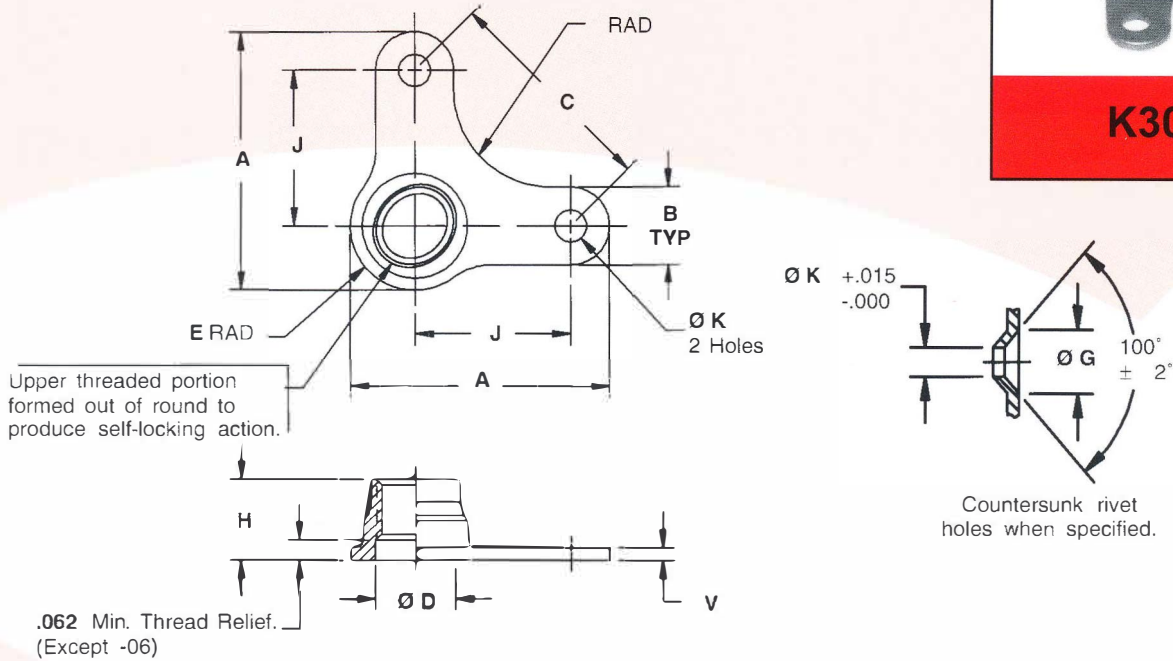

PART NUMBER	THREAD (MIL-S-8879)	A MAX	B REF	C ± .002	D MIN	E REF	G ± .010	H MAX	J ± .002	K +.005 -0.000	V REF	APPROX WT LBS/100
K3000-06	.1380-32 UNJC-3B	.637	.250	.486	—	.133	.200	.145	.344	.098	.032	.20
K3000-08	.1640-32 UNJC-3B	.637	.250	.486	.168	.149	.200	.215	.344	.098	.032	.24
K3000-3	.1900-32 UNJF-3B	.653	.250	.486	.194	.164	.200	.220	.344	.098	.032	.25
K3000-4	.2500-28 UNJF-3B	.852	.250	.707	.254	.207	.200	.281	.500	.098	.040	.50
K3000-5	.3125-24 UNJF-3B	.914	.322	.707	.317	.253	.230	.328	.500	.130	.050	.77
K3000-6	.3750-24 UNJF-3B	.968	.322	.707	.379	.307	.230	.344	.500	.130	.055	.95
K3000-7	.4375-20 UNJF-3B	1.101	.342	.795	.442	.363	—	.390	.562	.161	.074	1.68

MATERIAL: Carbon steel per AMS 5085 (UNS G10500) or alloy steel per AMS 6322 (UNS G8740).

FINISH: Cadmium plate per QQ-P-416, Type II, Class 2 and Kaylube molybdenum disulfide dry film lubricant per MIL-L-46010.

PERFORMANCE: MIL-N-25027.

VARIATIONS: Add "BC" for bottom countersunk rivet holes. Example: K3000-3BC.

K3000

ANCHOR NUT
CORNER

K3000