

Anchor Nuts (Metric)

MKM4000

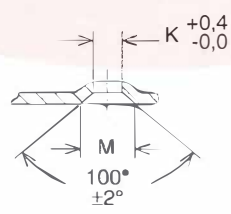

DETAIL "BC" CODED PARTS

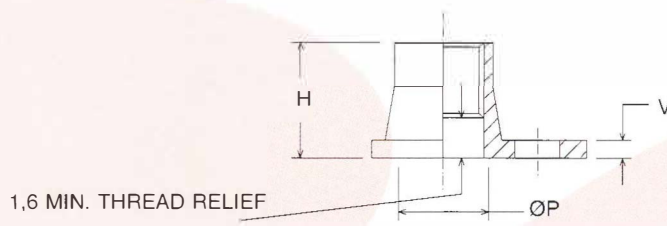
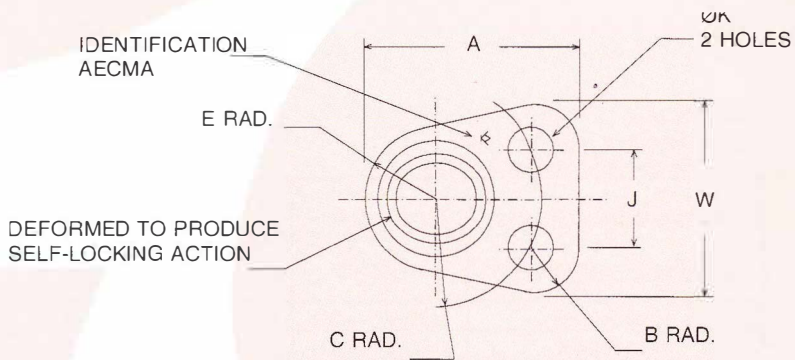

PART NUMBER	THREAD	A MAX	B REF	C ±0,1	E REF	H MAX	J ±0,05	K +0,2 -0,0	M ±0,25	P ±0,05	V MAX	W MAX
MKM4000-040	M4 0,70	12,0	2,5	6,0	4,0	5,2	5,5	2,5	4,8	4,2	1,00	10,5
MKM4000-050	M5 0,80	13,6	2,5	7,0	4,5	6,2	5,5	2,5	4,8	5,2	1,00	10,5
MKM4000-060	M6 1,00	15,7	3,0	8,0	5,0	7,1	5,5	2,5	4,8	6,2	1,25	11,5

**MATERIAL:** C1050 carbon steel per AMS 5085 (UNS G10500).

**FINISH:** Cadmium plate per QQ-P-416, Type II, Class 2 and Kaylube molybdenum disulfide dry film lubricant per MIL-L-46010.

**THREAD DATA:** Thread Profile: ISO 5855/1 and to MJ minor dia. Tolerances: ISO 5855/2. Class 4H5H.

**PERFORMANCE:** AECMA 2053. (Tensile strength based on 1100 MPa).

**TEMPERATURE:** 235°C.

**VARIATION:** Add "BC" for bottom c'sunk rivet holes. Example: MKM4000-050BC.

**DIMENSIONS:** NFL 22556. LN 29678.

**MKM4000**

**ANCHOR NUT**  
**SHORT LUG MINIATURE**

**MKM4000**