

DEFORMED TO PRODUCE
SELF-LOCKING ACTION

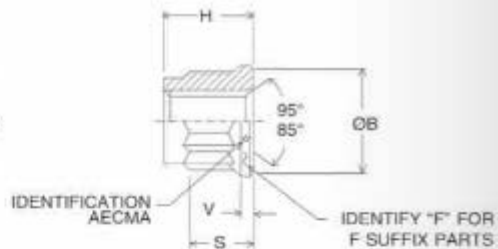

PART NUMBER <i>Designation</i>	THREAD <i>Filetage</i>	A MAX Mini	B MIN Mini	C MIN Mini	H MAX Maxi	S $\pm 0,2$	V $\pm 0,2$	W MAX Maxi	
HM20-050	M5	0,80	9,5	8,8	7,8	7,0	4,4	1,5	7,0
HM20-060	M6	1,00	10,5	9,8	8,9	8,0	5,0	1,6	8,0
HM20-070	M7	1,00	12,0	11,3	10,0	9,0	5,5	1,7	9,0
HM20-080	M8	1,25	13,5	12,8	11,2	10,5	6,3	1,8	10,0
HM20-080F	M8	1,00	13,5	12,8	11,2	10,5	6,3	1,8	10,0
HM20-100	M10	1,50	16,5	15,8	13,4	13,0	7,8	2,2	12,0
HM20-100F	M10	1,25	16,5	15,8	13,4	13,0	7,8	2,2	12,0
HM20-120	M12	1,50	19,5	18,8	15,6	15,0	9,0	2,8	14,0
HM20-120F	M12	1,25	19,5	18,8	15,6	15,0	9,0	2,8	14,0
HM20-140	M14	1,50	23,0	22,3	18,9	17,0	10,5	2,8	17,0
HM20-160	M16	1,50	26,0	25,3	21,1	19,0	12,5	3,0	19,0
HM20-180	M18	1,50	29,0	28,3	24,5	22,0	14,0	3,2	22,0
HM20-200	M20	1,50	32,0	31,3	26,7	24,5	16,0	3,4	24,0

MATERIAL: Alloy steel per AMS 6304 (UNS K14675)
or 8740 alloy steel per AMS 6322 (UNS G87400).

FINISH: Cadmium plate per QQ-P-416, Type II,
Class 2 and Kaylube molybdenum disulfide dry
film lubricant per MIL-L-46010.

THREAD DATA: Thread Profile: ISO 5855/1 and
to MJ minor diameter.
Tolerances: ISO 5855/2. Class 4H5H.

PERFORMANCE: AECMA 2053 (Tensile strength
based on 1550 MPa).

TEMPERATURE: 235°C.

DIMENSIONS: NFL 22519 (except dia.14 to 20),
LN 29919.

NOTE: ΔC and "W" dimensions apply before forming
self-locking action.

HM20

TWELVE POINT NUT

HM20

METRIC

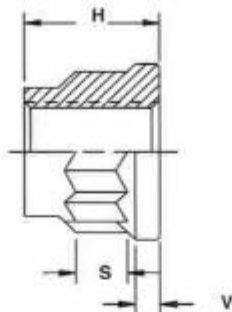
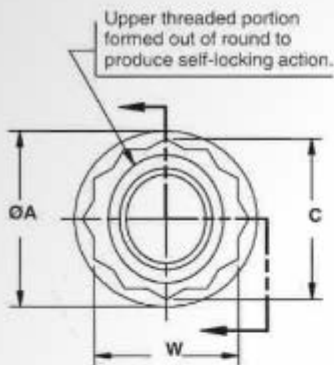

PART NUMBER	THREAD (MIL-S-8879)	A MAX	C MIN	H MAX	S MIN	V REF	W	AXIAL TENSILE STRENGTH LBS. MIN.	APPROX WT LBS/100
H20-4	.2500-28 UNJF-3B	.460	.491	.359	.100	.045	.376-.367	8,900	.64
H20-5	.3125-24 UNJF-3B	.560	.491	.421	.125	.050	.439-.430	14,100	1.00
H20-6	.3750-24 UNJF-3B	.670	.561	.468	.155	.060	.502-.492	20,900	1.50
H20-7	.4375-20 UNJF-3B	.770	.631	.531	.165	.075	.564-.553	28,300	2.10
H20-8	.5000-20 UNJF-3B	.870	.706	.578	.180	.080	.627-.616	37,800	2.80
H20-9	.5625-18 UNJF-3B	.950	.775	.633	.205	.090	.690-.679	47,900	3.60
H20-10	.6250-18 UNJF-3B	1.050	.881	.687	.235	.100	.783-.772	59,900	5.00
H20-12	.7500-16 UNJF-3B	1.250	1.059	.796	.310	.120	.940-.928	86,900	8.80
H20-14	.8750-14 UNJF-3B	1.438	1.200	.968	.345	.140	1.064-1.052	119,000	12.50
H20-1612	1.0000-12 UNJF-3B	1.625	1.331	1.156	.395	.160	1.194-1.177	154,600	18.00

MATERIAL: Alloy steel per AMS 6304 (UNS K14675). Heat treat - Rc 48 maximum.

FINISH: H20-(*) - Cadmium plate per QQ-P-416, Type II, Class 2 and Kaylube molybdenum disulfide dry lubricant per MIL-L-46010.
 H20X-(*) - Cadmium plate per QQ-P-416, Type II, Class 2.
 H20-(*)CW - Cadmium plate per QQ-P-416, Type II, Class 2 and cetyl alcohol lubricant.

PERFORMANCE: MIL-N-25027, except as follows:
 a. Axial tensile strength as tabulated.

NOTES: "C" and "W" dimensions apply before forming self-locking feature.

H20

TWELVE POINT NUT

H20

220,000 PSI