

DEFORMED TO PRODUCE  
SELF-LOCKING ACTION

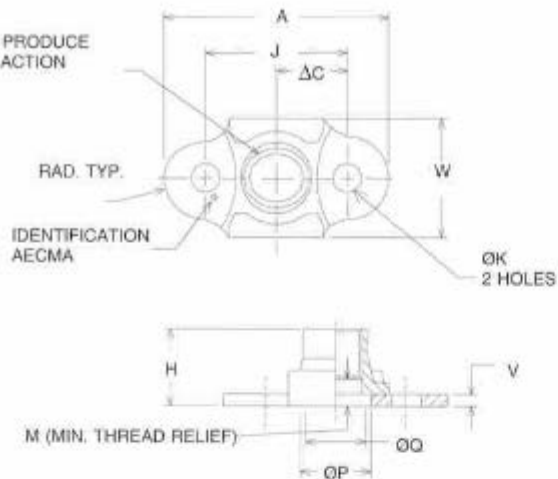

PART NUMBER	THREAD		A	C	H	J	K	M	P	Q	V	W
			MAX	Δ	MAX	±0,05	+0,2 -0,0	±0,25	±0,05	MIN	MAX	MAX
MFM5000-040	M4	0,70	17,2	6,0	5,1	12,0	2,5	1,6	5,0	4,2	0,6	9,8
MFM5000-050	M5	0,80	19,2	7,0	6,1	14,0	2,5	1,6	6,0	5,2	0,8	10,6
MFM5000-060	M6	1,00	21,2	8,0	6,8	16,0	2,5	1,6	7,0	6,2	0,8	12,3

**MATERIAL:** C1050 carbon steel per AMS 5085 (UNS G10500).

**FINISH:** Cadmium plate per QQ-P-416, Type II, Class 2 and Kaylube molybdenum disulfide dry film lubricant per MIL-L-46010.

**THREAD DATA:** Thread Profile: ISO 5855/1 and to MJ minor dia.  
Tolerances: ISO 5855/2. Class 4H5H.

**PERFORMANCE:** AECMA 2053 (Tensile strength based on 1100 MPa).

**TEMPERATURE:** 235°C.

**DIMENSIONS:** LN 29910.

**FLOATABILITY:** 0,5 minimum radially from centre.

# MFM5000 ANCHOR NUT MFM5000

TWO LUG, MINIATURE, FLOATING, METRIC

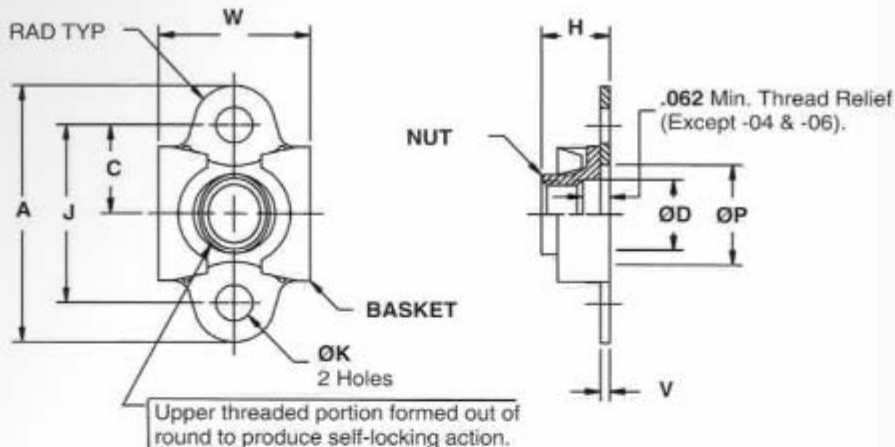

PART NUMBER	THREAD (MIL-S-8879)	A MAX	C ±.005	D MIN	H MAX	J ±.002	K +.005 -.000	P REF	V REF	W MAX	APPROX WT LBS/100
MF5000-04	.1120-40 UNJC-3B	.651	.203	—	.153	.406	.098	.164	.020	.315	.25
MF5000-06	.1380-32 UNJC-3B	.682	.220	—	.171	.437	.098	.190	.020	.357	.25
MF5000-08	.1640-32 UNJC-3B	.707	.234	.168	.250	.468	.098	.214	.025	.367	.28
MF5000-3	.1900-32 UNJF-3B	.739	.250	.194	.250	.500	.098	.240	.025	.416	.30
MF5000-4	.2500-28 UNJF-3B	.801	.281	.254	.281	.562	.098	.300	.032	.500	.49
MF5000-5	.3125-24 UNJF-3B	1.010	.359	.317	.328	.718	.130	.375	.032	.581	—

**MATERIAL:** C1050 carbon steel per AMS 5085 (UNS G10500).

**FINISH:** MF500-(\*) -Cadmium plate per QQ-P-416, Type II, Class 3 and Kaylube molybdenum disulfide dry lubricant per MIL-L-46010.

MF500-(\*)CW-Cadmium plate per QQ-P-416, Type II, Class 3 and Kaywax.

MF500(\*) -Cadmium plate per QQ-P-416, Type II, Class III.

**FLOATABILITY:** .030 min. radially from center.

**MF5000**

**ANCHOR NUT**  
MINIATURE, FLOATING, TWO-LUG

**MF5000**